

System pontoons 1800, 2400

System 1800 and **2400** are modular timber pontoon designs using polyethylene plastic floats. They are designed for use as mooring and general purpose pontoons. The strong wooden frame makes it possible to connect boat booms to the pontoon. The units are connected by flexible rubber bolt joints. The pontoon is easy to transport and simple to assemble.

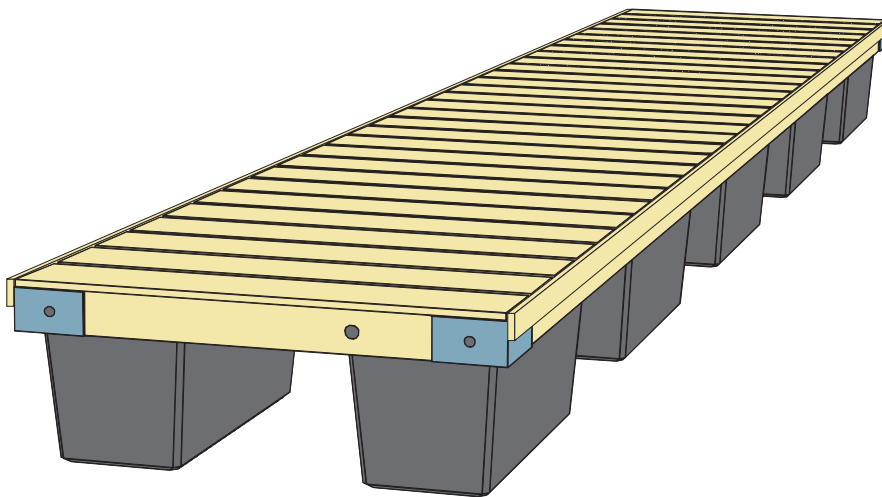

TECHNICAL DATA

Plastic floats: Shell of polyethylene, core of polystyrene, density 20 kg/m³

Timber: Pressure impregnated, graded pine

Deck: Planed and grooved, 28x120 mm

Standard features: Hot dip galvanised steel corner braces

Optional accessories: Cable tray, timber fenders

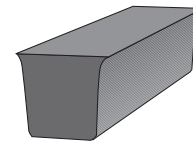

Plastic float M30

Dimensions: 1040x580x530 mm

Weight: 10 kg

Capacity: 260 kg

STANDARD PONTOON ELEMENTS	P606	P608	P912	N606	N608	N912
Length (m)	6,0	6,0	9,0	6,0	6,0	9,0
Width (m)	1,8	1,8	1,8	2,4	2,4	2,4
Floats M30 (no.)	6	8	12	6	8	12
Weight (kg)	440	460	720	570	590	880
Net capacity (kN/m ²)	1,0	1,5	1,5	0,7	1,0	1,0
Freeboard (m)	0,50	0,55	0,55	0,45	0,50	0,50
Joint gap (mm)	25	25	25	25	25	25

In addition to the above mentioned sizes, elements of special dimensions are also available.

Exact unit weight and freeboard are subject to timber water content and pontoon equipment.

Marinetek operates a policy of continuous development and reserves the right to change specifications without notice.

Revision date: 15.01.2008

MARINETEK GROUP

Vattuniemenkatu 3
FI-00210 Helsinki, Finland
WEB www.marinetek.net

TEL. +358 (0)9 682 4100
FAX +358 (0)9 682 41030
EMAIL info@marinetek.net

MARINETEK
More than Surface

